



Delaware Crescent

Shoeburyness

£185,000



Delaware Crescent



Description

* Investors Only * GREAT VALUE FOR MONEY!! Two DOUBLE bedroom ground floor flat in Shoeburyness boasting NO ONWARD CHAIN, a LONG LEASE and private rear garden! Positioned within close proximity to public transport links, local amenities and popular schools.

- NO ONWARD CHAIN
- Double Glazing
- Private Rear Garden
- Well Managed Block
- Close to Public Transport Links
- Two Double Bedrooms
- Gas Central Heating
- Long Lease
- Ground Floor
- Investors Only



Shoeburyness



Floor Plan

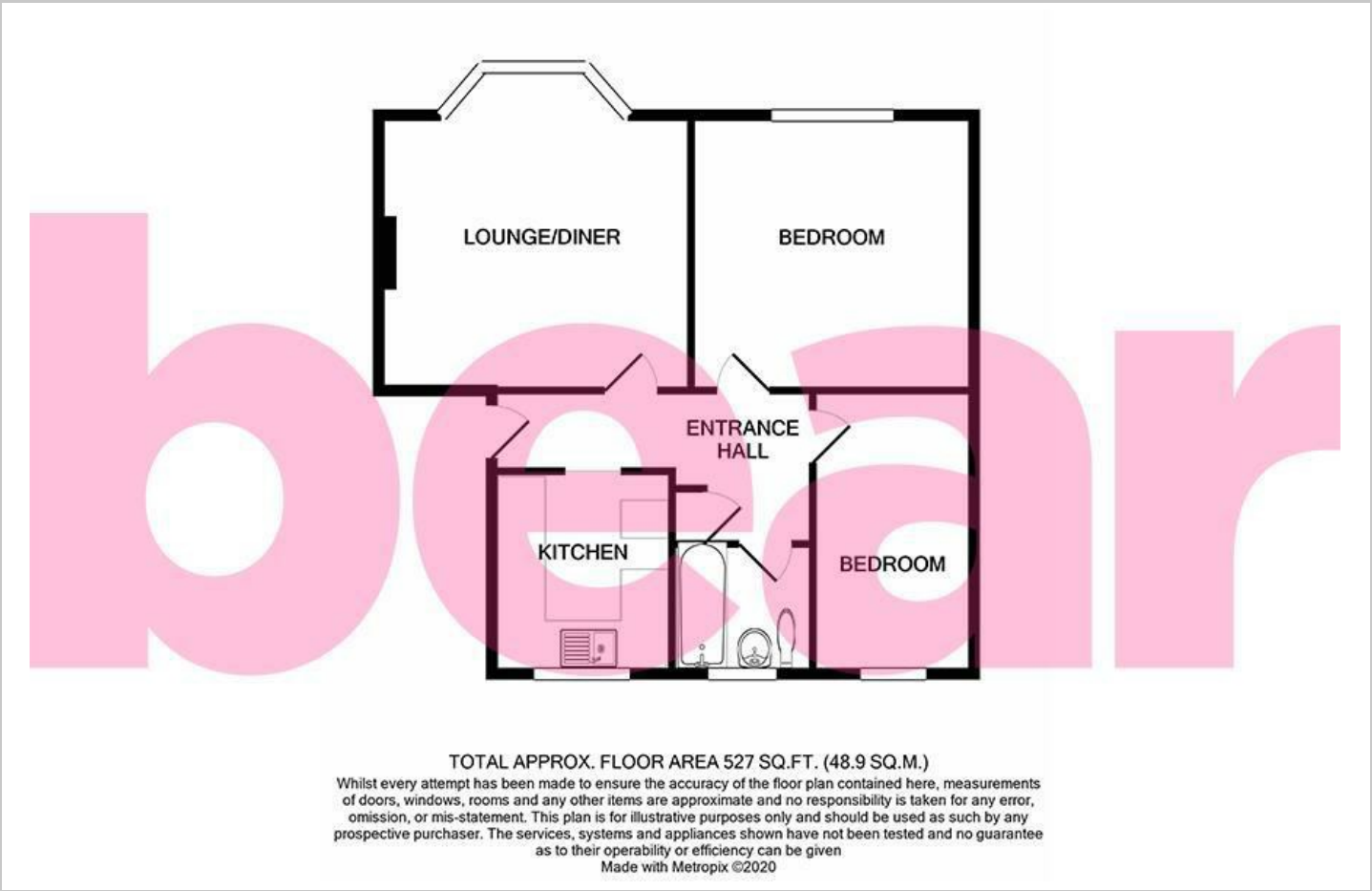

Area Map



Energy Efficiency Graph

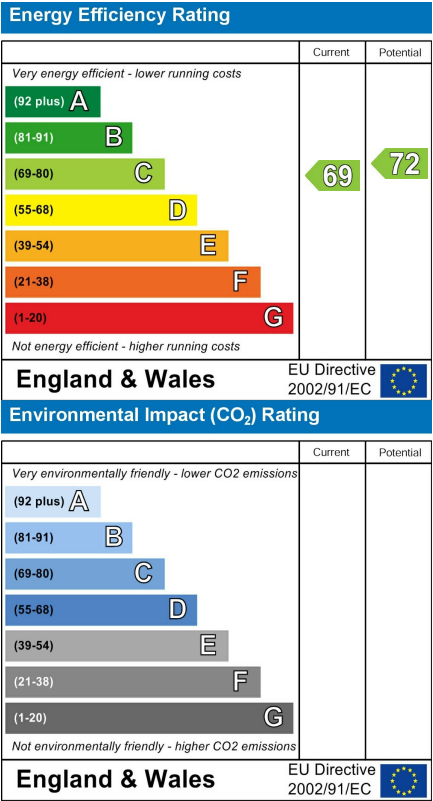

Viewing

Please contact our Southend-on-Sea Office on 01702 811211 if you wish to arrange a viewing appointment for this property or require further information.

These particulars, whilst believed to be accurate are set out as a general outline only for guidance and do not constitute any part of an offer or contract. Intending purchasers should not rely on them as statements of representation of fact, but must satisfy themselves by inspection or otherwise as to their accuracy. No person in this firms employment has the authority to make or give any representation or warranty in respect of the property.

Beech House, 1 Journeymans Way, Temple Farm Industrial Estate, Southend-on-Sea, Essex, SS2 5TF

Office: 01702 811211 info@bearestateagents.co.uk <https://www.bearestateagents.co.uk>